

# ALIGNMENT PROCEDURE FOR THE SKY-BUDDY MODEL 5T

## I. F. ALIGNMENT

- 1 AFTER REMOVING THE GRID CAP OF THE 6A7 TUBE CONNECT THE SIGNAL GENERATOR TO THIS TUBE, GROUND OF THE GENERATOR TO CHASSIS.
- 2 SET GENERATOR TO 465 KC; SET TUNING GANG TO MINIMUM CAPACITY.
- 3 HAVE BAND SWITCH SET FOR #1 BAND.
- 4 LEAVE VOLUME CONTROL ON FULL; A.V.C. SWITCH IN "OFF" POSITION.
- 5 WITH AN INSULATED SCREW DRIVER ADJUST THE TRIMMERS ON THE 1ST AND 2ND I.F. TRANSFORMERS UNTIL MAXIMUM SIGNAL STRENGTH IS SECURED.  
IF AN OUTPUT METER IS AVAILABLE CONNECT TO VOICE COIL LEADS OF THE SPEAKER OR FROM SCREEN TO PLATE OF THE 42 TUBE THROUGH A SUITABLE COUPLING CONDENSER.

## R. F. ALIGNMENT

- 1 REMOVE SIGNAL GENERATOR LEAD FROM 6A7 TUBE; REPLACE GRID WIRE TO TUBE CAP; CONNECT SIGNAL GENERATOR TO ANTENNA (RED) WIRE.
- 2 BE SURE BAND SWITCH IS ON #1 BAND.
- 3 SET GENERATOR AND RECEIVER TO 1400 KC.
- 4 ADJUST 1400 KC OSCILLATOR TRIMMER LOCATED ON THE BOTTOM OF THE CHASSIS, AND SO INDICATED, FOR MAXIMUM SIGNAL.
- 5 SET GENERATOR AND RECEIVER TO 600 KC.
- 6 ADJUST 600 KC PAD LOCATED ON THE TOP OF THE CHASSIS FOR MAX SIGNAL.
- 7 TURN BAND SWITCH TO #2 BAND AND GO THROUGH THE ABOVE PROCEDURE FOR THE TWO FREQUENCIES INDICATED FOR THIS BAND - 4MC BELOW THE CHASSIS 1.8MC ON THE TOP.
- 8 TURN BAND SWITCH TO #3 BAND AND GO THROUGH THE ABOVE PROCEDURE - 14MC BELOW THE CHASSIS, AND THEN CHECK 6MC WITH THE GENERATOR. THERE IS NO LOW-FREQUENCY PAD ON THIS BAND. 6MC SHOULD FALL PLUS OR MINUS 1/2 TO 1 DIVISION NEAR 6MC WITH NO FURTHER ADJUSTMENT.

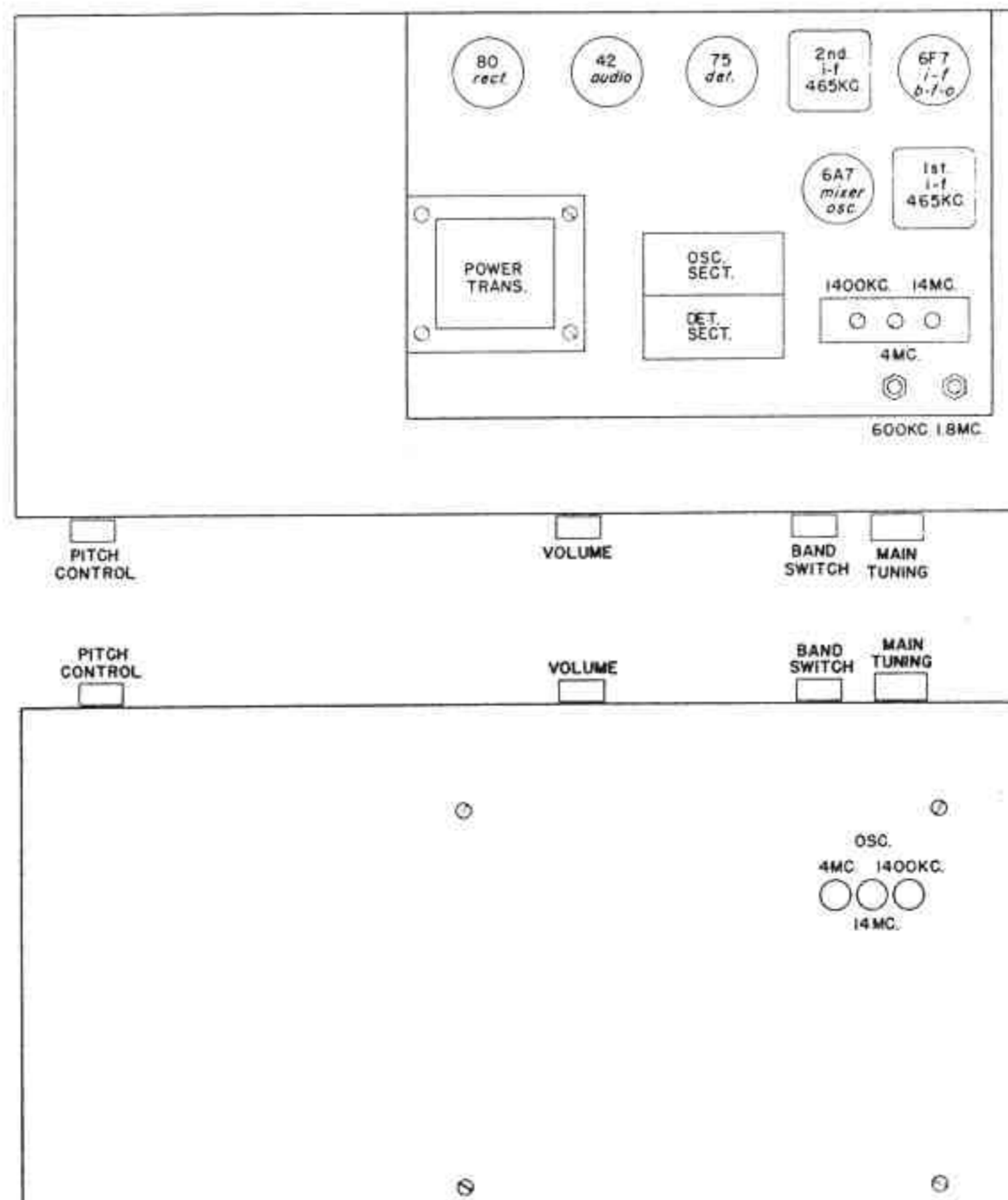

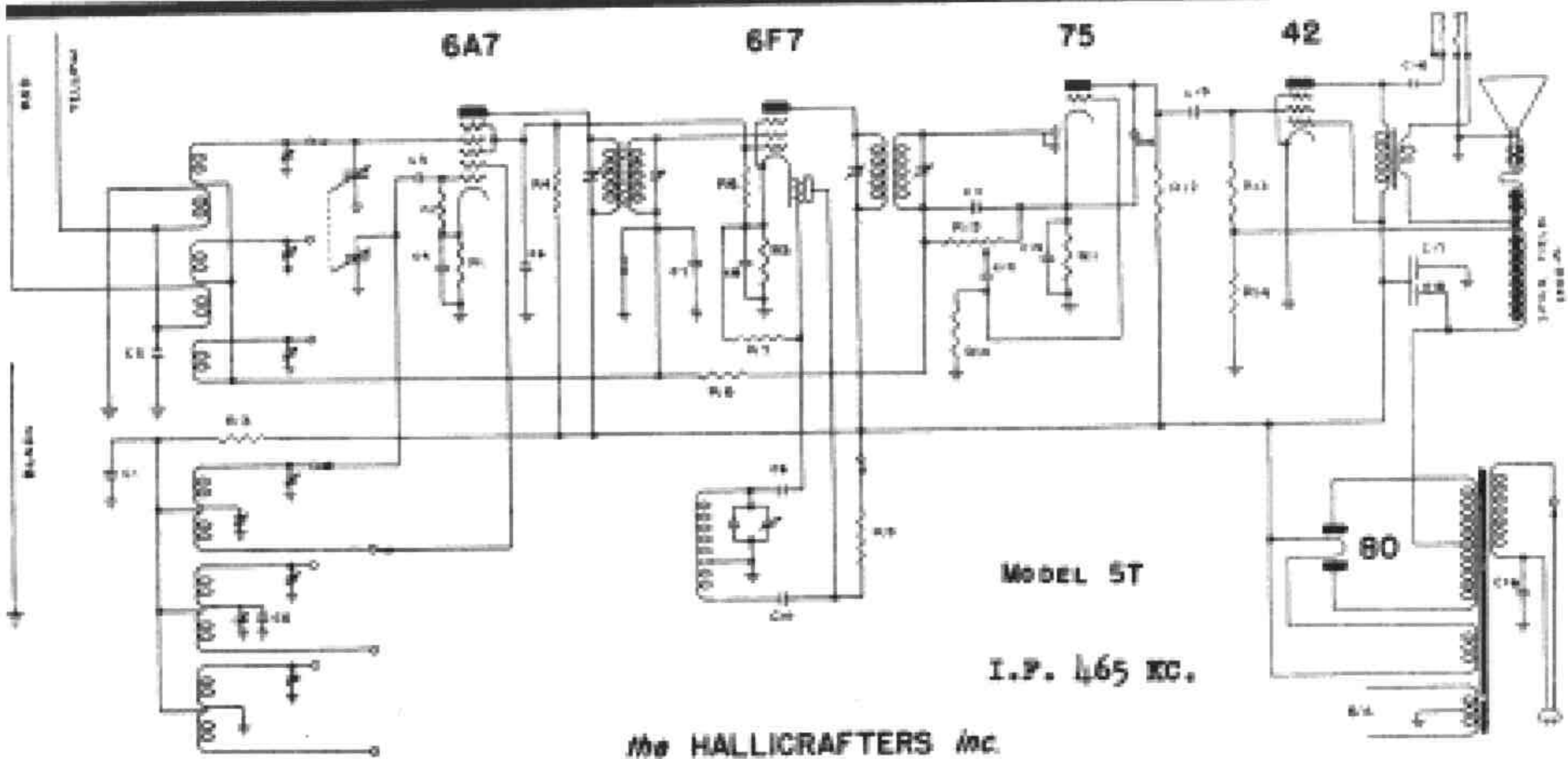

Model 5T  
I.F. 465 KC.

The HALLICRAFTERS Inc.  
SKY BUDDY

C1	.1	400
C2	10 mf	
C3	100 mf	
C4	.1	200
C5	1000 mf	
C6	.1	400
C7	.05	200
C8	.1	200
C9	250	
C10	.01	400
C11	250 mf	
C12	.01	400
C13	.1	200

C14	250 mf	
C15	.01	400
C16	.05	400
C17	5.mfd	
C18	4.mfd	
C19	.01	400

R1	250
R2	30,000
R3	25,000
R4	25,000
R5	200
R6	25,000
R7	100,000
R8	1 meg
R9	100,000
R10	1 meg
R11	4000
R12	250,000
R13	400,000
R14	250